

FORM No. 1.

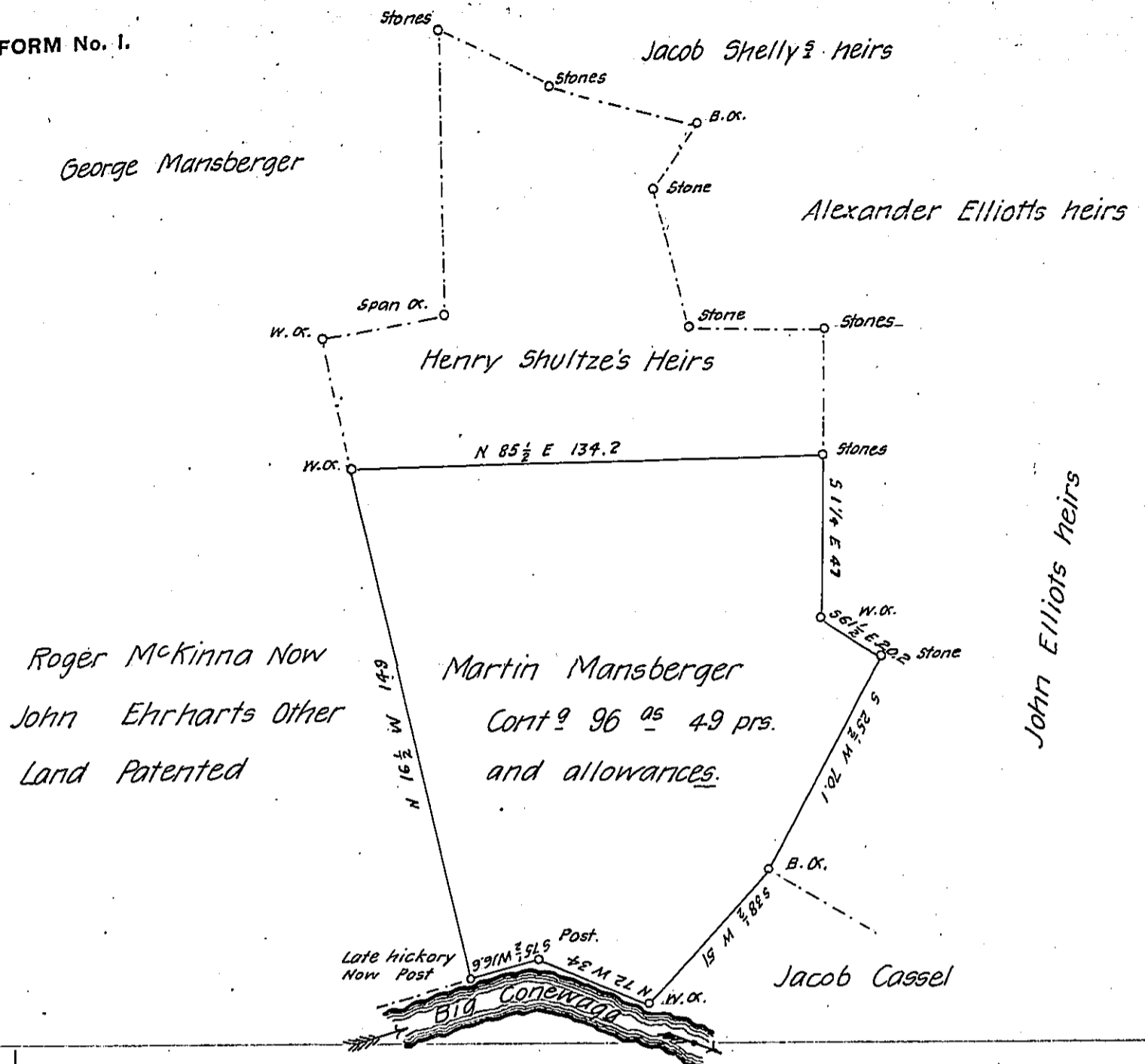

A draught of a piece of land situate in Newbury Township in the County of York Containing as above set forth 96^{as} 49 pers. and the usual allowances which is part of 143^{as} 149 prs & allowances Originally surveyed in pursuance of the Application No. 5024 for 300^{as} dated the first day of June 1768 granted to Martin Mansberger

Now on the 4th day of December A.D. 1839 at the request of John Ehrhart the present owner to make return of the same who wishes to patent the same & having examined the above and found it correct do make return accordingly &

Per
James Ohail D.S.

To Jacob Sallade Esq
Surveyor General.

IN TESTIMONY that the above is a copy of the original remaining on file in the Department of Internal Affairs of Pennsylvania, made conformably to an Act of Assembly approved the 16th day of February, 1833, I have hereunto set my Hand and caused the Seal of said Department to be affixed at Harrisburg, this first day of March 1906

Isaac N. Brown
Secretary of Internal Affairs.